

V2 ES1 HD

Glass to Wall T Shape
 90° Heavy Duty Shower Hinge

Technical Details

- Manufactured in brass
- Dual action hinge opening inwards and outwards
- Self closing from approximately 25 degrees
- Suitable for 10 & 12mm glass
- Maximum door width for 10mm glass is 1000mm
- Maximum door weight = 50kgs
- Stud fixing recommended for all glass to wall applications

Available Finishes

- Satin chrome
- Special finishes upon request (lead time applies)



V2 ES1 HD SAT

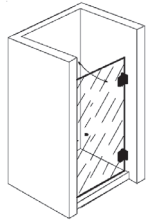

Glass Cutout Options

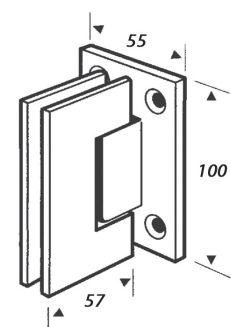
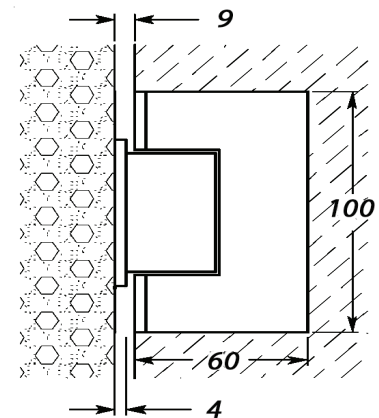
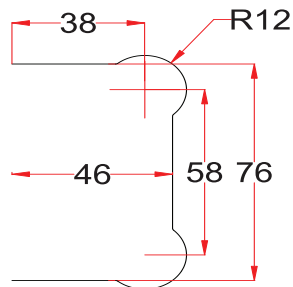
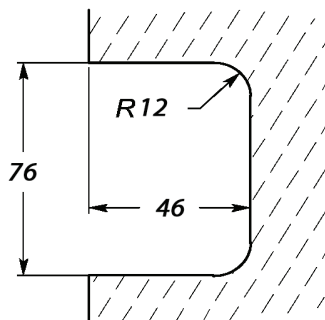

V2 ES1L HD

Glass To Wall L Shape 90° Heavy Duty Shower Hinge

Technical Details

- Manufactured in brass
- Dual action hinge opening inwards and outwards
- Self closing from approximately 25 degrees
- Suitable for 10mm glass
- Maximum door width for 10mm glass is 1000mm
- Maximum door weight = 50kgs
- Stud fixing recommended for all glass to wall applications

Available Finishes

- Polished chrome
- Satin chrome
- Special finishes upon request (lead time applies)



V2 ES1L HD C



V2 ES1L HD SAT

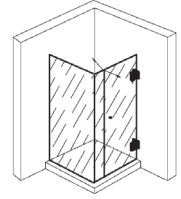

Glass Cutout Options

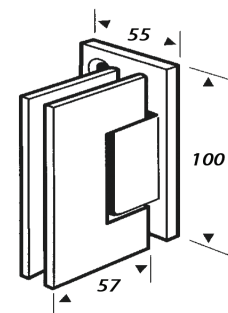
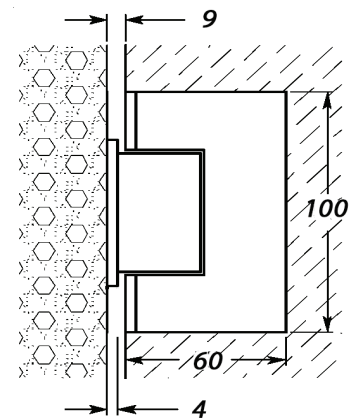
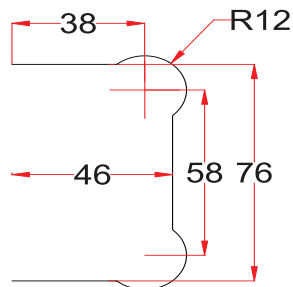
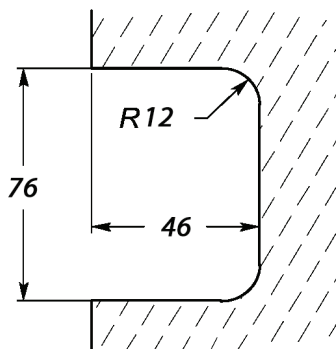

V2 ES2 HD

Glass To Glass 180° Heavy Duty Shower Hinge

Technical Details

- Manufactured in brass
- Dual action hinge opening inwards and outwards
- Self closing from approximately 25 degrees
- Suitable for 10mm glass
- Maximum door width for 10mm glass is 1000mm
- Maximum door weight = 50kgs

Available Finishes

- Polished chrome
- Satin chrome
- Special finishes upon request (lead time applies)



V2 ES2 HD C

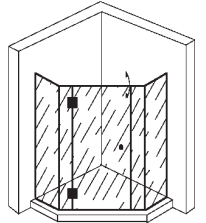
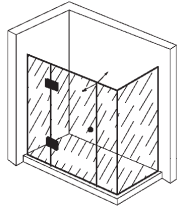

V2 ES2 HD SAT

Glass Cutout Options

